



KOHLER
ARCHITECTURE
1110 WEST FRONT STREET
MONROE, MICHIGAN 48161
WWW.KOHLERARCHITECT.NET

MAKE
Things Better⁺



DATE: 03.16.2026
DESCRIPTION: BIDDING & STATE REVIEW

CONCRETE WALK REPLACEMENT AT B-WING
MONROE HIGH SCHOOL
901 HERR ROAD, MONROE, MICHIGAN 48161
MONROE PUBLIC SCHOOLS
1275 N. MACOMB STREET, MONROE, MI 48162

JOB # 26107

PARTIAL SITE PLAN

A1.00

BASE BID:
CONTRACTOR TO REMOVE XT'G. CONCRETE APRON AND FOUNDATION AND INSTALL NEW PER DETAIL. UNIT PRICE U-1: CONTRACTOR TO RE-USE XT'G. APRON AND FOUNDATION IF FOUND TO BE ACCEPTABLE CONDITION AND DEPTH.

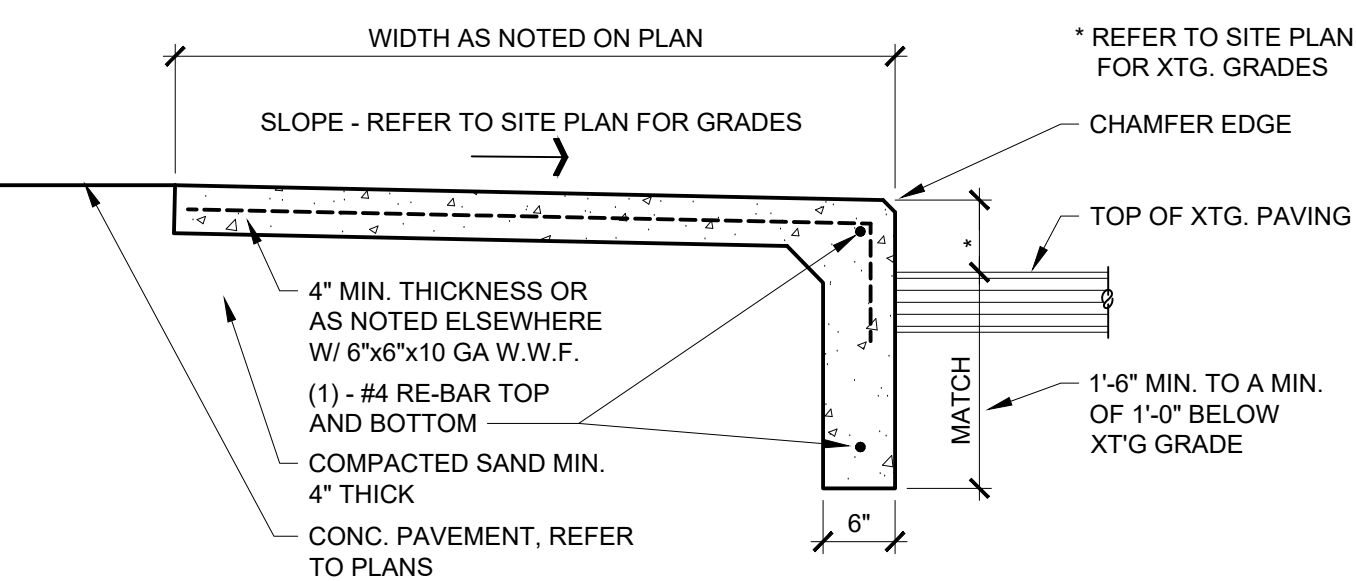
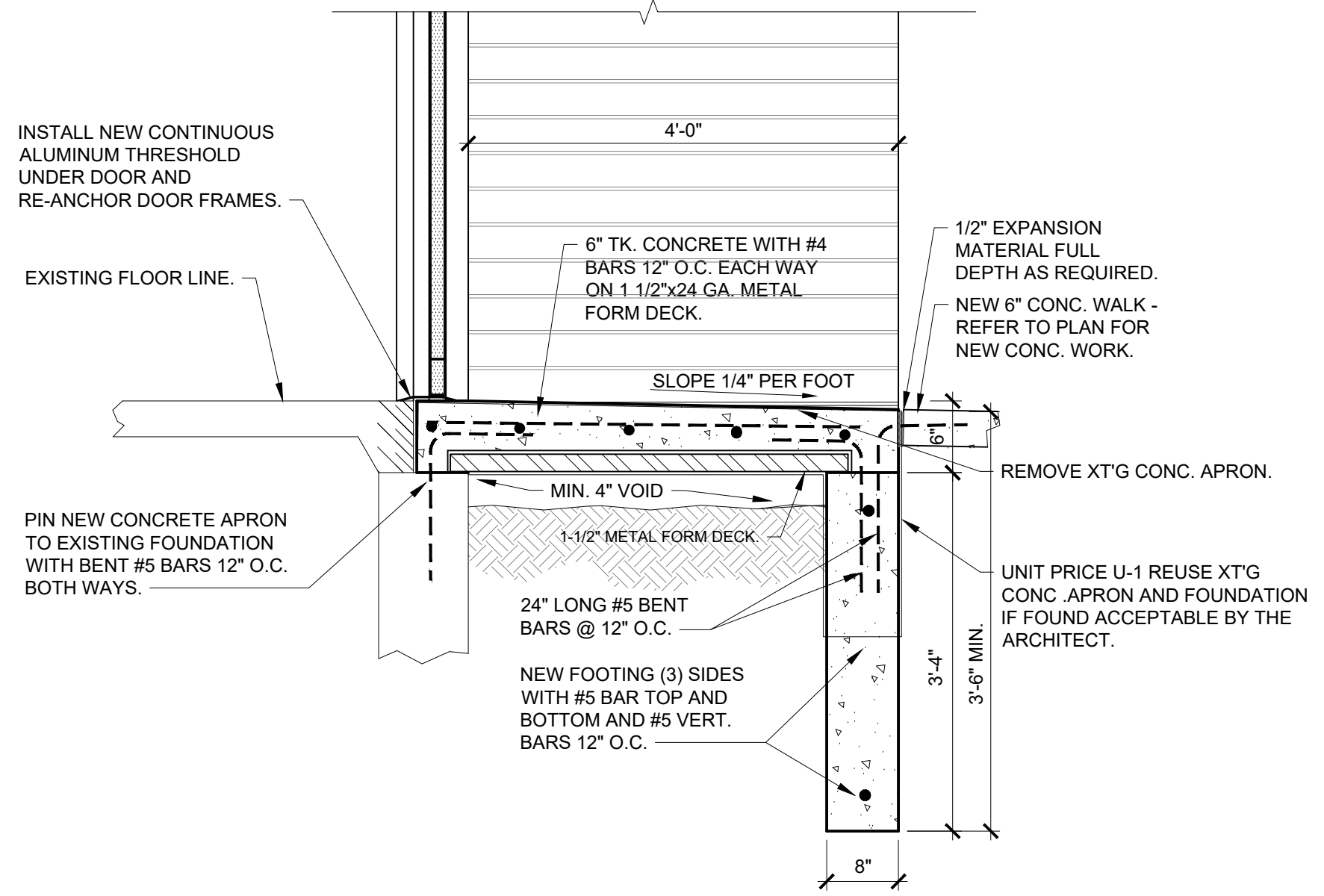
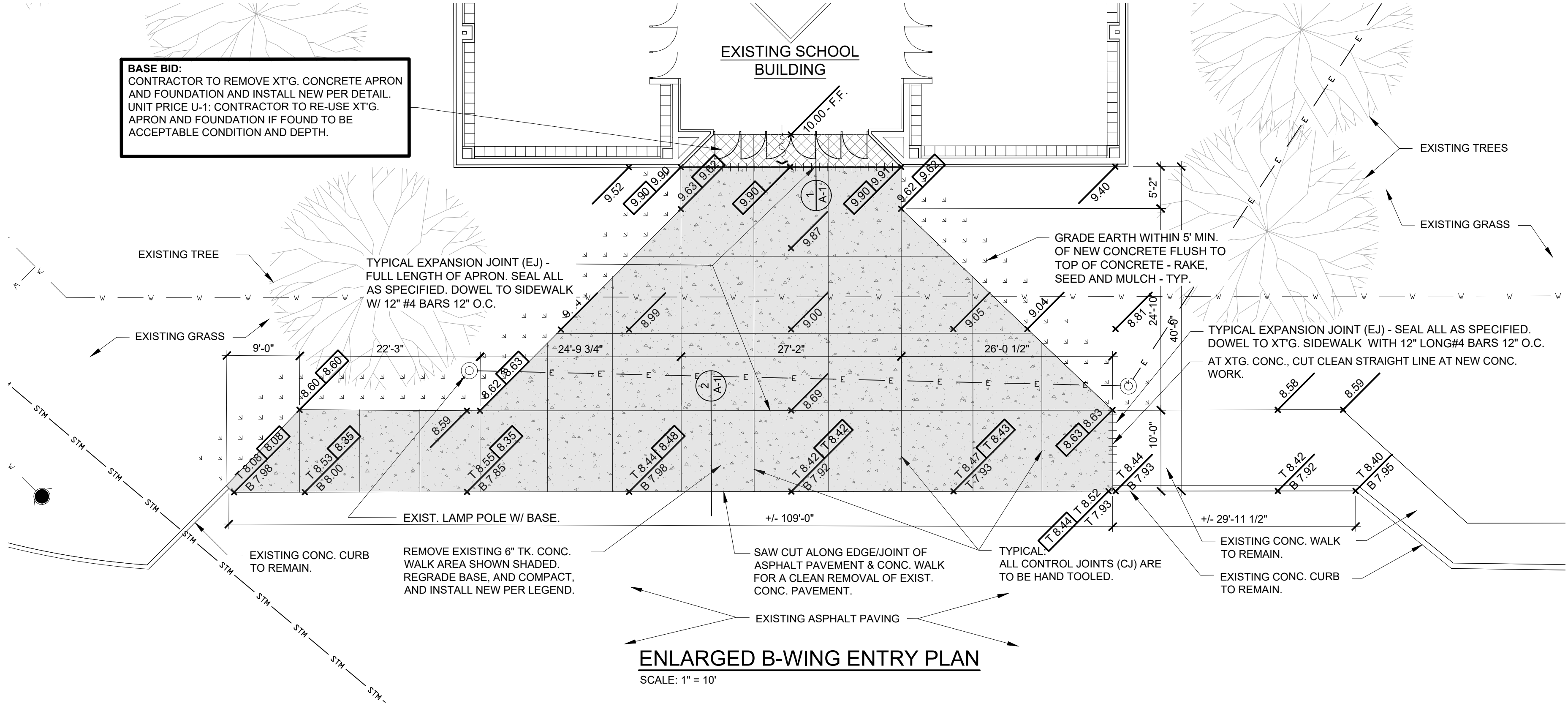

DRAWING INDEX

SHEET	DESCRIPTION
A1.00	GENERAL NOTES, DRAWING INDEX, KEY PLAN, ENLARGED C-WING ENTRY PLAN, CONC. APRON DETAIL, SITE LEGEND
A2.00	GENERAL NOTES

GENERAL NOTES

- ALL WORK SHALL BE DONE IN STRICT ACCORDANCE WITH APPLICABLE SECTIONS OF THE FEDERAL, STATE AND LOCAL BUILDING CODES, ZONING ORDINANCES, HEALTH AND FIRE REGULATIONS AS ADOPTED BY THE LOCAL GOVERNING BUILDING AUTHORITY.
- CONTRACTOR SHALL OBTAIN AND PAY FOR ALL NECESSARY BUILDING PERMITS FROM ALL GOVERNING AGENCIES INCLUDING THE CITY / TOWNSHIP AND SUBMIT FOR THEIR USE ANY CERTIFICATES OF INSURANCE, BONDS, ESCROW ACCOUNTS, LICENSES, PAY ALL FEES, OBTAIN ALL APPROVALS, ETC. ALL AS MAY BE REQUIRED TO COMPLETE THIS PROJECT.
- CONTRACTOR SHALL RETAIN THE SERVICES OF AN APPROVED THIRD PARTY AGENCY TO PERFORM ALL SPECIAL INSPECTIONS AND TESTING AS REQUIRED BY THE LOCAL GOVERNING BUILDING CODE, GOVERNING BUILDING AUTHORITY, OR AS CALLED OUT IN THESE CONSTRUCTION DOCUMENTS. NOTIFY OWNER / ARCHITECT, IMMEDIATELY, OF ANY FAILED TESTS OR INSPECTIONS AND PROVIDE OWNER WITH ALL WRITTEN REPORTS AND TEST RESULTS AT PROJECT COMPLETION.
- CONTRACTOR SHALL VERIFY ALL EXISTING DIMENSIONS AND CONDITIONS BEFORE PROCEEDING WITH THE WORK.
- DETAIL SYMBOL: DETAIL NUMBER FROM SHEET REFERRED TO OR FROM
- THESE DOCUMENTS ARE DEVELOPED TO PROVIDE THE CONTRACTOR WITH A WORKING KNOWLEDGE OF THE SYSTEMS TO BE INSTALLED AND SCOPE OF WORK. WHERE THESE DETAILS ARE IN CONFLICT WITH THE STANDARD DETAILS OR SPECIFICATIONS OF THE MANUFACTURED COMPONENT, OR AFFECT THE GUARANTEE, THEY SHALL BE MODIFIED AS REQUIRED BY THE CONTRACTOR AND APPROVED BY THE ARCHITECT.
- PROVIDE AND MAINTAIN SUITABLE TEMPORARY FENCES, BARRICADES, LIGHTS, WARNINGS, ETC., FOR PROTECTION OF PUBLIC AND OTHERS HAVING ACCESS TO THE SITE. CONTRACTOR SHALL KEEP CLEAN AND ADEQUATELY PROTECT ALL STREETS, DRIVES, WALKS, BLDGS, ETC., FROM DAMAGE DUE TO ANY ITEM INVOLVED WITH THIS WORK. ANY DAMAGED WORK SHALL BE REPLACED / REPAIRED AT CONTRACTORS EXPENSE.
- CONTRACTOR SHALL LOCATE ALL UNDERGROUND UTILITIES BY CONTACTING "MISS DIG", RESPONSIBLE UTILITY COMPANY, REVIEW ALL SURVEYS, AS BUILT DRAWINGS, AND SEEK ANY OTHER INFORMATION FROM THE OWNER, PRIOR TO BEGINNING EXCAVATIONS.

LANDSCAPING NOTES

- LAWN AREAS - GRASS
REPAIR EXISTING LAWN AREAS, DOUBLE AERATE AND OVERSEED. INSURE POSITIVE AND CONSISTENT GRADE ACROSS ALL LAWN AREAS, REGRADE ANY INCONSISTENT AREAS DEEMED NECESSARY.
SEED MIX:
80% - TURF TYPE TALL FESCUE
10% - KENTUCKY BLUEGRASS
10% PERENNIAL RYEGRASS
RATE: 7 LBS. / 1,000 S.F.
- EACH CONTRACTOR IS TO VERIFY WITH OWNER AND UTILITY COMPANIES, THE LOCATIONS OF ALL UTILITIES PRIOR TO CONSTRUCTION TO DETERMINE IN THE FIELD THE ACTUAL LOCATIONS AND ELEVATIONS OF ALL EXISTING UTILITIES, WHETHER SHOWN ON THE PLANS OR NOT. THE CONTRACTOR SHALL CALL MISS DIG PRIOR TO ANY CONSTRUCTION AND UTILITY PROTECTION SERVICE 72 HOURS PRIOR TO CONSTRUCTION.
- CONTRACTOR SHALL MAINTAIN POSITIVE DRAINAGE IN LAWN AREAS.
- FINE GRADE LAWN AREAS TO PROVIDE SMOOTH AND CONTINUAL GRADE FREE OF IRREGULARITIES OR DEPRESSIONS.
- CONTRACTOR SHALL SEED OR SOD ALL AREAS DISTURBED DURING CONSTRUCTION - SEE PLAN.

SOIL EROSION NOTES

- EROSION AND SEDIMENT CONTROL MEASURES ARE TO BE PLACED PRIOR TO, OR AS THE FIRST STEP IN CONSTRUCTION. SEDIMENT CONTROL PRACTICE AND CONSTRUCTION BARRIERS WILL BE APPLIED AS A PERIMETER DEFENSE AGAINST ANY TRANSPORTING OF SILT OFF THE SITE.
- CONTRACTOR SHALL APPLY TEMPORARY EROSION AND SEDIMENTATION CONTROL MEASURES AS REQUIRED AND AS DIRECTED ON THE PLANS. THE TEMPORARY MEASURES SHALL BE REMOVED AS SOON AS PERMANENT STABILIZATION OF SLOPES, DITCHES, AND OTHER EARTH CHANGES HAVE BEEN ACCOMPLISHED.
- ALL MUD / DIRT TRACKED ONTO EXISTING STREETS FROM THIS SITE, DUE TO CONSTRUCTION, SHALL BE PROMPTLY REMOVED BY THE CONTRACTOR.
- DUST CONTROL - CONTRACTOR SHALL KEEP ALL PUBLIC ROADS AND DRIVES CLEAN WITHIN THE PROJECT LIMITS. ALL HAUL ROADS SHALL BE KEPT FREE FROM DUST AND DIRT. IF THEY ARE NOT MAINTAINED, THEY SHALL REQUIRE THE CONTRACTOR TO USE MECHANICAL CLEANING EQUIPMENT TO REMOVE DUST AND PARTICLES FROM THE ROADWAY SURFACE AND MINIMIZE THE CHANCE OF SUCH PARTICLES BECOMING AIR-BORNE. THE SITE WILL BE SPRAYED WITH WATER ON DRY WINDY DAYS.
- RESTORATION - ALL EXISTING FEATURES DESIGNATED TO REMAIN THAT ARE DISTURBED DUE TO CONSTRUCTION, SUCH AS PARKING LOT, DRIVES, LAWN, SEWERS, CATCH BASINS, SEEDED AREAS, ETC. SHALL BE REPAIRED IN KIND TO THEIR ORIGINAL CONDITION IN ACCORDANCE WITH SPECIFICATIONS AND THE SATISFACTION OF OWNER.

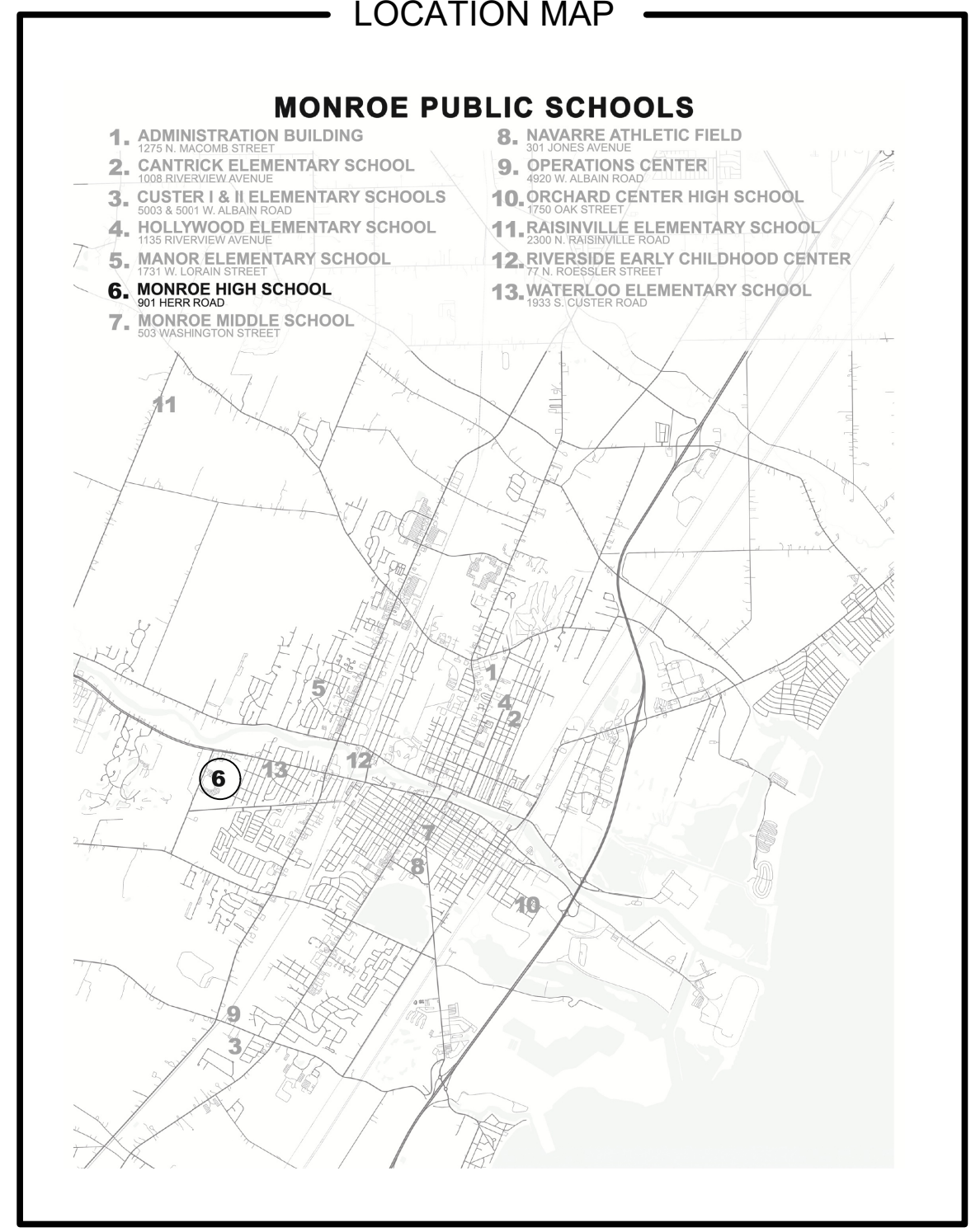
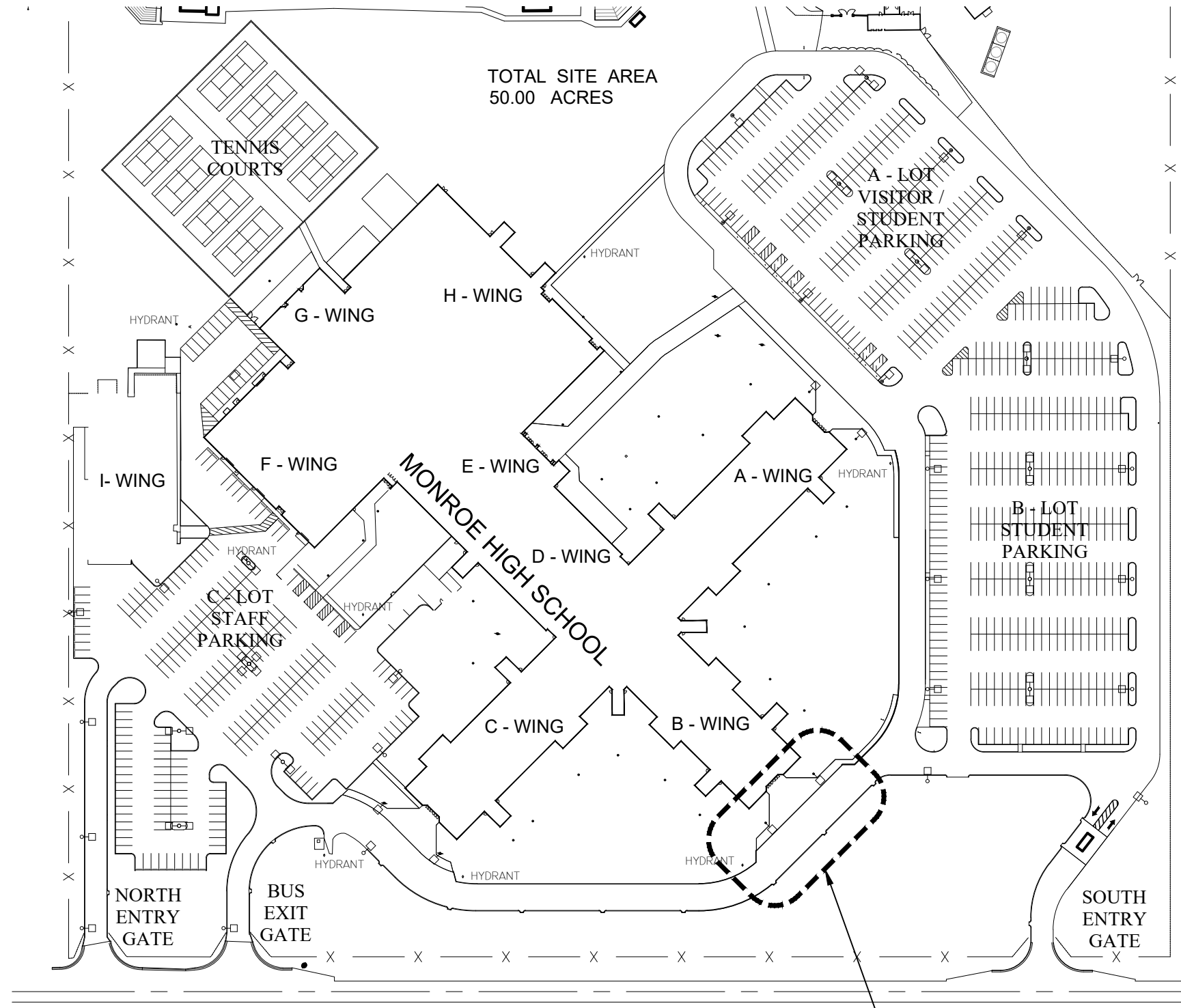

SITE LEGEND

- WATER
- FENCE
- U.G. ELECTRIC - DEPTH UNKNOWN
- U.G. STORM SEWER - DEPTH UNKNOWN
- FIRE HYDRANT
- LIGHT POLE
- EXISTING SPOT ELEVATIONS
- PROPOSED NEW SPOT ELEVATIONS (BOXED)
- DIRECTION OF NEW SURFACE SLOPE

- UNIT PRICE U-1: CONTRACTOR TO REMOVE XT'G. CONCRETE APRON AND FOUNDATION AND INSTALL NEW PER DETAIL. UNIT PRICE U-1: CONTRACTOR TO RE-USE XT'G. APRON AND FOUNDATION IF FOUND TO BE ACCEPTABLE CONDITION AND DEPTH. CONTRACTOR TO INCLUDE UNIT PRICE ON PROPOSAL FORM FOR NEW APRON INSTALLATION, IF REQUIRED.
- INSTALL NEW 6" CONCRETE WALK AS DETAILED - GRADE AND COMPACT SUBGRADE TO A MINIMUM 95% UNIT DENSITY. INSTALL NEW MIN. #21AA STONE BASE TO MEET PROPOSED FINISH GRADES
- INSTALL NEW TOPSOIL WITHIN 5 FEET OF NEW CONCRETE WALK AREAS TO PROVIDE A MINIMUM OF 1% SLOPE AS REQUIRED AGAINST NEW WALKS TO BLEND TO ADJACENT GRADES - GRADE, RAKE, SEED & MULCH



**Know what's below.
Call before you dig.**



KOHLER
ARCHITECTURE

1110 WEST FRONT STREET
MONROE, MICHIGAN 48161
WWW.KOHLERARCHITECT.NET

MAKE
Things Better⁺

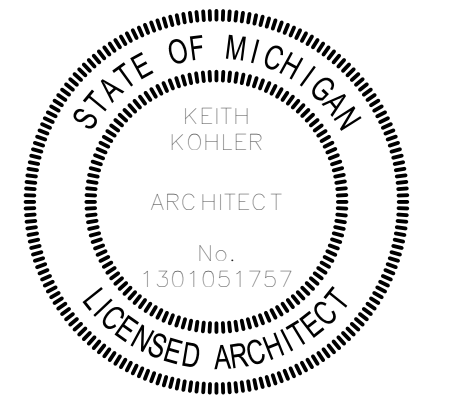

DATE	DESCRIPTION
03.16.2026	BIDDING & STATE REVIEW

CONCRETE WALK REPLACEMENT AT B-WING

AT
FOR

MONROE HIGH SCHOOL
901 HERR ROAD, MONROE, MICHIGAN 48161

MONROE PUBLIC SCHOOLS
1275 N. MACOMB STREET, MONROE, MI 48162

JOB # 26107

GENERAL NOTES

A2.00

STRUCTURAL NOTES AND MATERIAL STRENGTHS

MISCELLANEOUS

- DISCREPANCIES BETWEEN ARCHITECTURAL AND STRUCTURAL PLANS SHALL BE BROUGHT TO ATTENTION OF ARCHITECT. ARCHITECTURAL PLANS SHALL GOVERN UNLESS STRENGTH OF STRUCTURE IS ADVERSELY AFFECTED.
- CONTRACTOR SHALL VERIFY ALL EXISTING DIMENSIONS, INTERFERENCES AND CONDITIONS PRIOR TO STARTING FABRICATION OR CONSTRUCTION AND REPORT ANY DISCREPANCIES TO THE OWNER.
- DO NOT BACK FILL AGAINST BASEMENT WALLS UNTIL FLOOR SLABS/DECKS HAVE BEEN CONSTRUCTED. IT IS THE CONTRACTORS SOLE RESPONSIBILITY TO DETERMINE ERECTION PROCEDURE AND SEQUENCE AND TO ENSURE TH SAFETY OF THE STRUCTURE AND ITS COMPONENTS DURING CONSTRUCTION. THIS INCLUDES PROVIDING TEMPORARY SHORING, BRACING , OR TIE DOWNS. THESE TEMPORARY SUPPORTS WILL REMAIN IN PLACE UNTIL ALL STRUCTURAL COMPONENTS HAVE BEEN COMPLETELY ERECTED.
- SOIL BEARING CAPACITIES USED FOR STRUCTURAL DESIGN:
STRIP FOOTINGS: 2,000 PSF
COLUMN FOOTINGS: 2,000 PSF
A SOIL ENGINEER SHALL VERIFY BEARING CAPACITY OF SOIL AT BOTTOM OF EXCAVATIONS BEFORE CONSTRUCTING FOOTINGS. IF THIS BEARING CAPACITY IS NOT FOUND, FOOTINGS SHALL BE LARGER OR LOWERED AT THE DIRECTION OF THE ARCHITECT.
- STRUCTURAL DESIGN LOAD DATA
FLOOR LOAD
COMMERCIAL: CONCRETE - 100 PSF. L.L. + 40 PSF. D.L.
WOOD - 100 PSF. L.L. + 25 PSF. D.L.
RESIDENTIAL: 40 PSF. L.L. + 20 PSF. D.L.
DEFLECTION = L/480
ROOF LOAD
ROOF/SNOW LOAD:
GROUND SNOW LOAD: PG = 25 PSF. L.L.
FLAT ROOF SNOW LOAD: PF = 30 PSF. L.L.
ROOF DEAD LOAD: 15 PSF.
SNOW EXPOSURE FACTOR: CE = 0.7
SNOW LOAD IMPORTANCE FACTOR: I = 1.0
WIND LOAD
BASIC WIND SPEED: 115 MPH
WIND LOAD IMPORTANCE FACTOR: I = 1.0
WIND EXPOSURE: B
SEISMIC IMPORTANCE I = 1.0
- ROOFING SHALL BE MINIMUM 15# FELT WITH MINIMUM 235#/SQ. CLASS 'A' SHINGLES AND GALVANIZED NAILS. ALL EAVES TO HAVE ICE-GUARD BARRIER FROM EAVE TO MINIMUM 2 FEET INSIDE WARM/INTERIOR SIDE OF WALL MEASURED HORIZONTALLY.
- SUBMIT (4) SETS (OR 1 SET ELECTRONIC) OF THE FOLLOWING SHOP DRAWINGS FOR APPROVAL PRIOR TO FABRICATION: CONCRETE REINFORCEMENT, MASONRY LINTELS, STRUCTURAL STEEL, METAL DECK, WATER STOP(S), STRUCTURAL / ENGINEERED WOOD COMPONENTS, ANCHORS. CONTRACTOR SHALL CHECK SHOP DRAWINGS PRIOR TO SUBMITTAL AND IS SOLEY RESPONSIBLE IN PREPARATION OF SHOP DRAWINGS TO CONFORM TO DESIGN DRAWINGS.

CONCRETE

- CONFORM TO LATEST EDITION OF FOLLOWING STANDARDS:
STANDARD SPECIFICATIONS FOR STRUCTURAL CONCRETE, ACI 301.
COLD WEATHER CONCRETING, ACI 306R.
HOT WEATHER CONCRETING, ACI 305R.
DETAILS AND DETAILING OF CONCRETE REINFORCEMENT, ACI 315.
GUIDE FOR CONCRETE FLOOR AND SLAB CONSTRUCTION, ACI 302.1R.
PLACING REINFORCING BARS, CRSI.
- CONCRETE COMPRESSIVE STRENGTH, UNLESS INDICATED:
GENERAL USE: 3,000 PSI
SLAB-ON-GRADE: 3,500 PSI
COLUMNS: 4,000 PSI
CONCRETE EXPOSED TO WEATHER SHALL HAVE 4% - 6% AIR ENTRAINED.
- REINFORCEMENT:
BARS: ASTM A615, GRADE 60.
WELDED WIRE FABRIC (WWF): ASTM A185.
- LAP REINFORCING BARS AS SHOWN, BUT NOT LESS THAN 36 BAR DIAMETERS. PROVIDE CORNER BARS EQUIVALENT IN SIZE AND NUMBER TO HORIZONTAL BARS AT CORNERS OF WALLS AND WALL FOOTINGS AND LAP WITH HORIZONTAL REINFORCEMENT. LAP WELDED WIRE FABRIC MINIMUM OF ONE WIRE SPACING PLUS 2".
- PROVIDE DOWELS IN COLUMN AND WALL FOOTINGS EQUIVALENT IN SIZE AND NUMBER TO VERTICAL BARS IN WALLS. EXTEND DOWELS 24 BAR DIAMETERS INTO FOOTING AND 24 BAR DIAMETERS INTO WALL OR COLUMN.
- PROVIDE REINFORCEMENT IN TOP OF INTERIOR WALL FOOTINGS CENTERED UNDER DOOR AND OTHER OPENINGS EQUIVALENT IN SIZE AND NUMBER TO BOTTOM REINFORCEMENT AND 4 FEET LONGER THAN OPENING.
- MINIMUM REINFORCEMENT UNLESS NOTED OTHERWISE:
WALLS 8" OR LESS IN THICKNESS: #5 @ 12" EACH WAY CENTERED IN WALL.
WALLS THICKER THAN 8": #5 @ 12" EACH WAY IN EACH FACE.
SLABS ON GRADE OR SLABS ON JOIST: 6"X6" - W2.1 X W2.1 W.W.F. UNLESS OTHERWISE NOTED
- CLEAR CONCRETE COVER ON REINFORCEMENT UNLESS NOTED:
CONCRETE DEPOSITED AGAINST GROUND: 3"
FORMED SURFACES EXPOSED TO WEATHER OR EARTH: 1-1/2" FOR #5 & SMALLER
2" FOR #6 BARS & LARGER
ALL OTHER SURFACES:
SLABS, WALLS AND JOISTS: 3/4"
BEAMS, GIRDERS & COLUMNS: 1-1/2"
- CHAMFER EXPOSED EDGES 3/4" X 45 DEGREES.
- FOOTINGS SHALL BE ON UNDISTURBED VIRGIN SOIL. FILL EXCESS CUTS WITH CONCRETE. MINIMUM FOOTING DEPTH TO BE 42" BELOW GRADE UNLESS NOTED OTHERWISE.
- EXTERIOR SIDE OF CONCRETE BELOW GRADE SHALL BE COATED WITH ASPHALTIC DAMP PROOFING
- PROVIDE ENTRY SLAB DECKING, DEPTH PER DRAWINGS X 0.0358 IN. THICK, FY = 33 KSI, G90 GALVANIZED.
- PROVIDE "WATERSTOP Rxx" OR APPROVED EQUAL WATERSTOPS AT ALL BELOW GRADE JOINT LOCATIONS.